

**HOUSEBOAT
HOLIDAY PRICES**

	DAY RATES (incl GST) 3 Days Minimum Hire (2 Nights)					BOND AMOUNT REQUIRED
	High Season (November 1 - May 31)		Low Season (June 1 - October 31)		CHRISTMAS / NEW YEAR	
	FRI - SUN	MON - THURS	FRI - SUN	MON - THURS	5 DAY MIN	
Miss Bianca (4 Berth)	\$480 Per Day	\$340 Per Day	\$360 Per Day	\$260 Per Day	\$510 Per Day	\$1000
Clancy (4/6 Berth) Chloe (4/6 Berth)	\$620 Per Day	\$450 Per Day	\$470 Per Day	\$340 Per Day	\$660 Per Day	\$2,000
Natalie Anne (6/8 Berth)	\$570 Per Day	\$400 Per Day	\$430 Per Day	\$310 Per Day	\$580 Per Day	\$1,000
Pelican (6/8 Berth) Lifestyle (6/8 Berth) Sarah Jane (6/8 Berth)	\$600 Per Day	\$420 Per Day	\$460 Per Day	\$330 Per Day	\$630 Per Day	\$1,000
Murray River Queen (7/9 Berth)	\$670 Per Day	\$470 Per Day	\$500 Per Day	\$360 Per Day	\$700 Per Day	\$1,000
Siesta (10 Berth) Hakuna Matata (8 Berth) Abby J (6/10 Berth) Sophie (6/8 Berth)	\$750 Per Day	\$540 Per Day	\$560 Per Day	\$400 Per Day	\$780 Per Day	\$2,000
Just Chillin (6/10 Berth)	\$800 Per Day	\$580 Per Day	\$610 Per Day	\$440 Per Day	\$840 Per Day	\$2,000
Quicksilver (8 Berth) Miss Emily (6/8 Berth)	\$860 Per Day	\$620 Per Day	\$660 Per Day	\$470 Per Day	\$910 Per Day	\$2,000

First Day Check in - Morning
Last Day Return - 3.00pm

DEPOSIT of \$200. Balance to be paid 4 weeks prior to departure.
For Christmas, New Year & Easter, balance payable 8 weeks prior to departure.
BOND payable upon check-in. Fuel is not included in the cost of houseboat hire.
***Weekend rate applies to Public Holidays**
***Conditions apply - prices subject to change without notice**

For accommodation only (fixed mooring at one of our two locations), availability, rates and details please call the office or check out our website.



MANDURAH House Boats



Cruise the beautiful Peel Inlet, Mandurah Canals & the Murray River.

Safe Boating!

**NO SKIPPERS
TICKET REQUIRED**



**ALL VESSELS ARE
EQUIPPED WITH:**

- All kitchenware, cleaning products and tea towels
- Cooktop
- Toilets and showers
- Hot water system
- Fridge/freezer
- 80L Esky
- BBQ
- DVD player
- Swim platform with ladder
- Shaded decks
- Outdoor settings
- Crab nets
- Ctrack Safety Tracking system
- GPS
- Inverter (to supply 240v suitable to charge mobile phones and laptops)

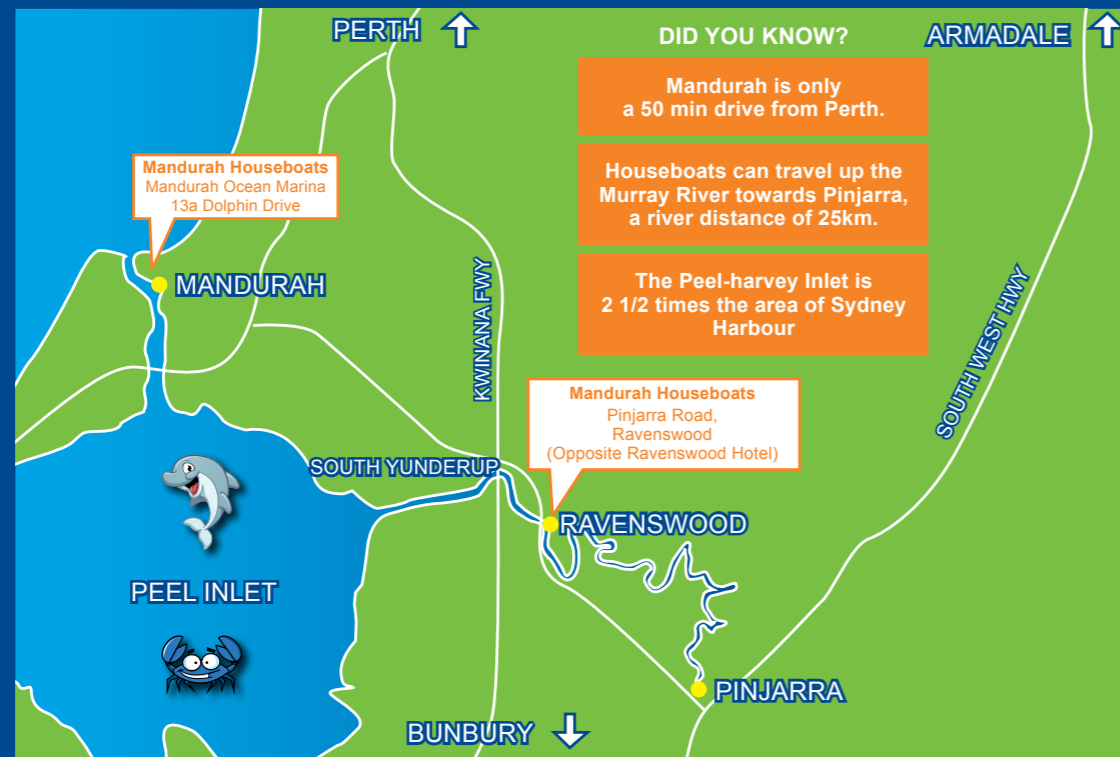

DID YOU KNOW?

Mandurah is only a 50 min drive from Perth.

Houseboats can travel up the Murray River towards Pinjarra, a river distance of 25km.

The Peel-harvey Inlet is 2 1/2 times the area of Sydney Harbour

Mandurah Houseboat Locations (See Map on Reverse)

Mandurah (Office)
13a Dolphin Drive,
Mandurah Ocean Marina
PO Box 565 Mandurah

Ravenswood
Pinjarra Road,
Ravenswood
(opposite Ravenswood Hotel)

For Bookings & Enquiries

Phone (08) 9535 9898 or email info@houseboatsmandurah.com.au
or visit our website www.houseboatsmandurah.com.au

ONLINE BOOKING AVAILABLE



Just Chillin 6/10 Berth

Just Chillin is a **spacious boat** with a very large lounge/dining/kitchen area. There is an equally **large back deck** area which also incorporates a raised deck area suitable for seating and a swim access platform which has an outdoor hot/cold shower. There is a queen bed, a bunk room with four bunks and up front 2 large sofas which fold down to make 2 double beds. There is a shower and 2 toilets.

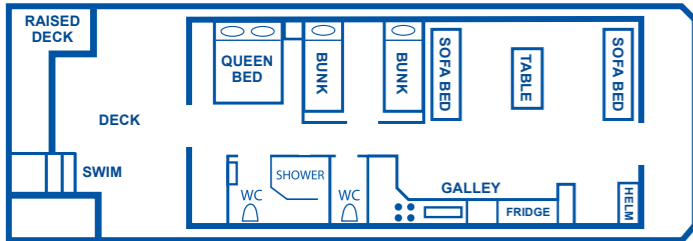

Sarah Jane 6/8 Berth

Sarah Jane has a double bed at the rear of the boat, a bunk room with 4 bunks and the 1 sofa lounge in the living room converts to a double bed. There is a spacious kitchen, a good sized living area and the front and rear decks are a good size. There is a shower and 2 toilets.

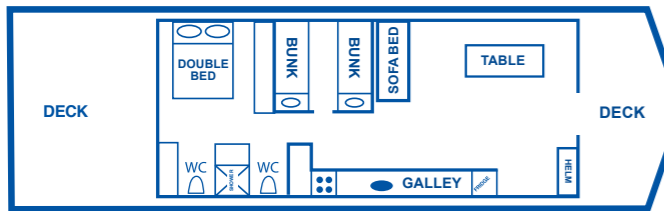

Sophie 6/8 Berth

Sophie has an open plan combined lounge/dining/kitchen area. Sophie has 2 double beds in separate rooms, a bunk room with 1 set of bunks and the 2 sofa beds in the living room convert to double beds. A good sized deck on the front of the boat, a shower and 2 toilets.

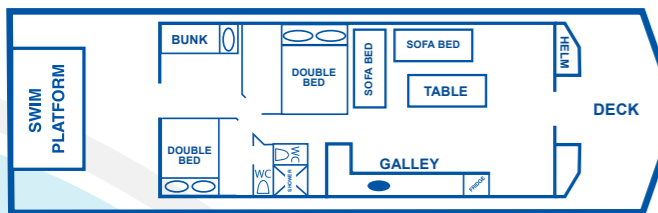

Clancy 4/6 Berth

This spacious houseboat is ideally suited for 2 couples, with 2 double bedrooms with a large comfortable L shape lounge which can convert to 2 single berths in living area. Rear bedroom has en-suite toilet, front bedroom has a toilet and shower.

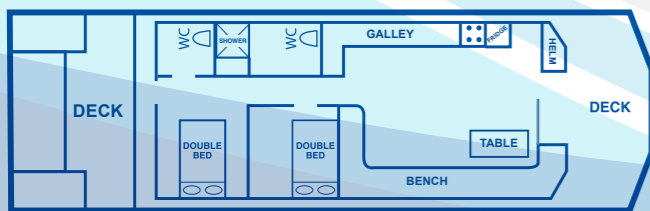

Pelican 6/8 Berth

Ideal for the bigger family or group of friends. Large, covered front deck and stereo speakers to both decks. 2 double bedrooms, 2 bunks in rear passage, 2 single berths in the living area, 1 shower and a toilet.

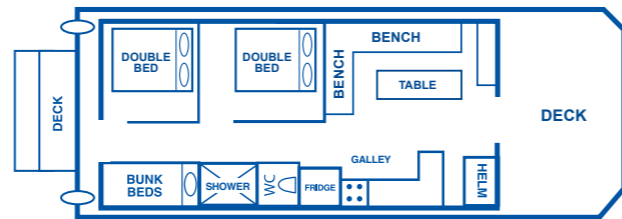

Siesta 10 Berth

This large, comfortable houseboat easily caters for 2 couples & 6 children. She offers 2 double bedrooms, a 3rd bedroom with 4 comfortable bunks, & 2 bunks in the rear passage. She has a spacious living area, with open kitchen, dining, shower and 2 toilets.

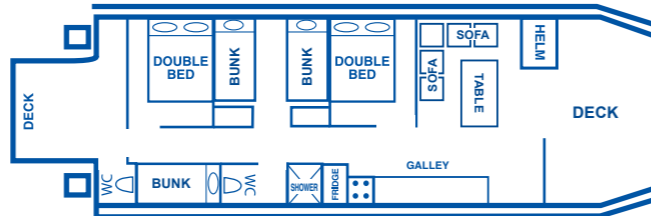

Hakuna Matata 8 Berth

("No worries"), this spacious vessel caters for 3 couples, with 3 comfortable double bedrooms, and 2 bunks in the rear alcove. Equipped with ample storage room, and large rear deck. As well as a shower and 2 toilets.

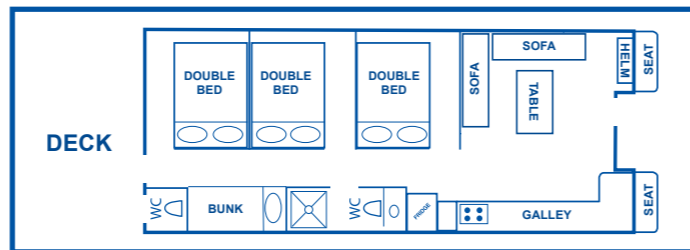

Quicksilver 8 Berth

Quicksilver has a **LUXURIOUS SPA**, air-conditioning/heating and tinted glass surrounds for panoramic cruising.

Suitable for two families – 2 bedrooms with double beds, 1 bedroom with 4 bunk beds. All linen is provided. There is a shower and 2 toilets. Galley includes Nespresso coffee machine, and microwave oven.

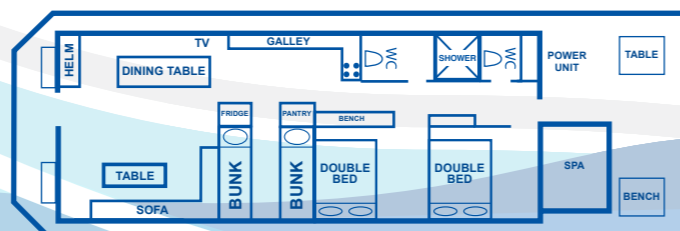

Miss Emily 6/8 Berth

Miss Emily is a luxury 2020 purpose built houseboat. Suitable for wheelchair users, she offers ramp access, spacious rooms, wide doorways/passageways and handrails in wet areas. The toilet/shower, helm, benchtops and light switches are all positioned to allow wheelchair users easy access.

Miss Emily can comfortably accommodate 8 people; offering 2 double bedrooms with queen sized beds, a set of bunks in the passageway and a pull out double sofa bed in the lounge room along with a shower and 2 toilets. A fully equipped galley includes a microwave and Nespresso coffee machine. Reverse cycle air-conditioning and all linen is also included. The large rear deck has a luxurious spa, BBQ and outdoor table and chairs.

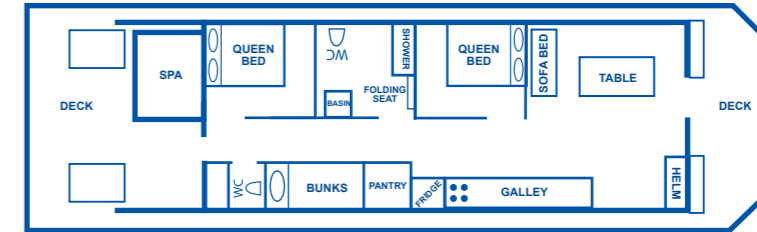

Lifestyle 6/8 Berth

Houseboat of choice for 2 couples & 2 children. Lifestyle has 2 comfortable double bedrooms, two bunks, a sofa bed that converts to a double bed, a shower and toilet.

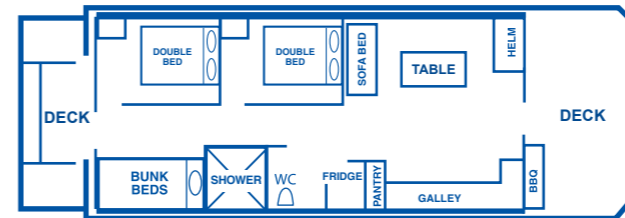

Miss Bianca 4 Berth

Popular budget family houseboat. Open planned vessel. Ideally suited for a couple, or parents with children. Sleeping arrangements are 1 double, 2 bunks. As well as a shower and toilet.

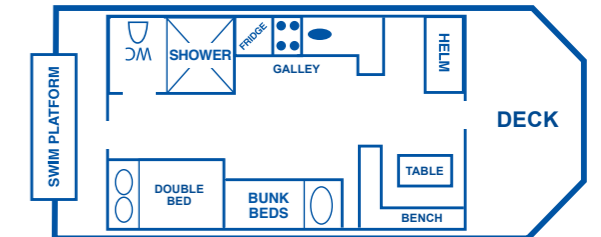

Murray River Queen 7/9 Berth

Suitable for a large family or a group of singles, Murray River Queen has a double bedroom, a second double bedroom with a single bunk above, two bunks in rear alcove, and sofa converts to a double bed. Equipped with a shower and 2 toilets.

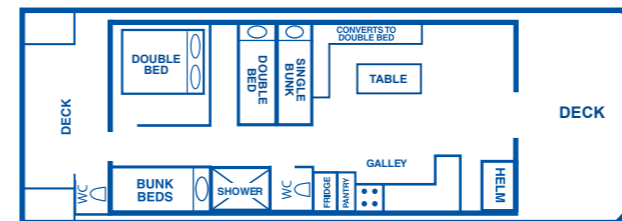

Natalie Anne 6/8 Berth

A Large, comfortable family houseboat with rear double bedroom, & second bedroom offering 4 spacious bunks. As well as a shower and toilet.

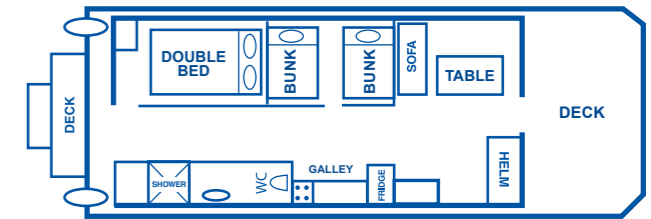

Abby J 6/10 Berth

A lovely spacious vessel with an open plan living/kitchen/dining area. The lounge room has 2 sofa lounges which convert to double beds. There are 2 double beds, a bunk room with 1 set of bunk beds, a shower and 2 toilets. A good sized deck on the front with BBQ and outdoor setting and a deck and swimming platform on the rear.

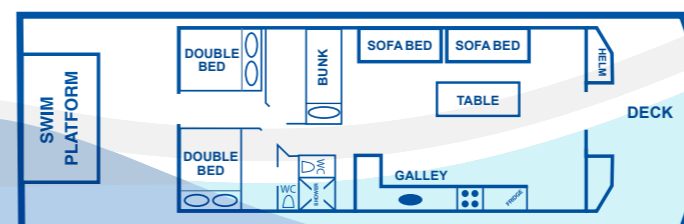

Chloe 4/6 Berth

Perfect for 2 couples with 2 double beds in separate rooms, a small double sofa bed in lounge, shower and 2 toilets. She has a spacious open plan living/kitchen/dining area and a large deck space front and rear. Chloe is the sister vessel to Clancy and they are almost identical but with different colour schemes.

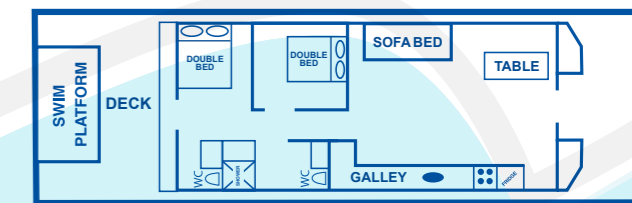

LEGEND

Embarkation
Mandurah Ocean
Marina

Embarkation
Ravenswood