



MANDURAH House Boats



Cruise the beautiful Peel Inlet, Mandurah Canals & the Murray River.

Safe Boating!

NO SKIPPERS TICKET REQUIRED

Mandurah Houseboat Locations (See Map on Reverse)

Mandurah (Office)
13a Dolphin Drive,
Mandurah Ocean Marina
PO Box 565 Mandurah

Ravenswood
Pinjarra Road,
Ravenswood
(opposite Ravenswood Hotel)

For Bookings & Enquiries

Phone (08) 9535 9898 or email info@houseboatsmandurah.com.au or visit our website www.houseboatsmandurah.com.au

ONLINE BOOKING AVAILABLE



DAY RATES (incl GST) 3 Days Minimum Hire (2 Nights)

HOUSEBOAT HOLIDAY PRICES	High Season (November 1 - May 31)		Low Season (June 1 - October 31)		CHRISTMAS / NEW YEAR / EASTER 5 DAY MIN	BOND AMOUNT REQUIRED
	FRI - SUN	MON - THURS	FRI - SUN	MON - THURS		
	Miss Bianca (4Berth)	\$440 Per Day	\$310 Per Day	\$350 Per Day		
Clancy Chloe (4/6 Berth) (4/6 Berth)	\$570 Per Day	\$410 Per Day	\$450 Per Day	\$330 Per Day	\$600 Per Day	\$2,000
Natalie Anne (6Berth)	\$520 Per Day	\$370 Per Day	\$410 Per Day	\$300 Per Day	\$530 Per Day	\$1,000
Pelican Lifestyle (6/8 Berth) Sarah Jane (6/8 Berth)	\$550 Per Day	\$390 Per Day	\$440 Per Day	\$320 Per Day	\$580 Per Day	\$1,000
Murray River Queen (8/10 Berth)	\$610 Per Day	\$430 Per Day	\$480 Per Day	\$350 Per Day	\$630 Per Day	\$1,000
Siesta Hakuna Matata (8 Berth) Abby J (6/10) Sophie (6/10)	\$680 Per Day	\$490 Per Day	\$540 Per Day	\$390 Per Day	\$710 Per Day	\$2,000
Just Chillin (6/10 Berth)	\$730 Per Day	\$530 Per Day	\$590 Per Day	\$420 Per Day	\$770 Per Day	\$2,000
Quicksilver (8 Berth)	\$790 Per Day	\$570 Per Day	\$630 Per Day	\$450 Per Day	\$830 Per Day	\$2,000

First Day Check in - Morning
Last Day Return - 3.00pm

DEPOSIT of \$200. Balance to be paid 4 weeks prior to departure. For Christmas, Easter, New Year. Balance payable 8 weeks prior to departure.
BOND payable upon check-in. Fuel is not included in the cost of houseboat hire.
*Conditions apply - prices subject to change without notice

For accommodation only (fixed mooring at one of our two locations), availability, rates and details please call the office or check out our website.



Abby J 6/10 Berth

A lovely spacious vessel with an open plan living/kitchen/dining area. The lounge room has two sofa lounges which convert to double beds. There are 2 double beds in separate rooms, a bathroom, a bunk room with one set of bunk beds, a powder room and a second toilet. A good sized deck on the front with BBQ and outdoor setting and a deck and swimming platform on the rear.

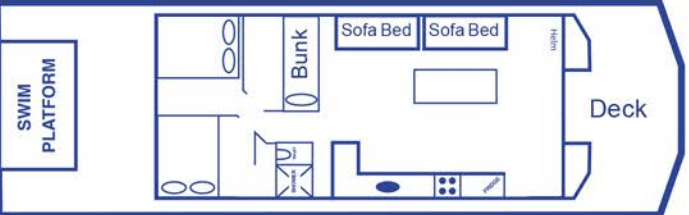

Pelican 6/8 Berth

Ideal for the bigger family or group of friends. Large, covered front deck and stereo speakers to both decks. Two double bedrooms, 2 bunks in rear passage and 2 single berths in the living area.

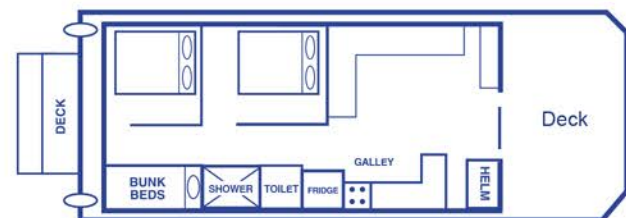

Just Chillin 6/10 Berth

Just Chillin is a spacious boat with a very large lounge/dining/kitchen area. There is an equally large back deck area which also incorporates a raised deck area suitable for seating and a swim access platform which has an outdoor hot/cold shower. There is a double bed, a bunk room with four bunks and up front two large sofas which fold down to make two double beds. In addition to a bathroom with shower and toilet there is a powder room with a second toilet.



Murray River Queen 8/10 Berth

Suitable for a large family or a group of singles, Murray River Queen has a double bedroom, a further two bedrooms with upper and lower bunks in each, two bunks in rear alcove, and sofa converts to a double bed. Equipped with a second powder room.

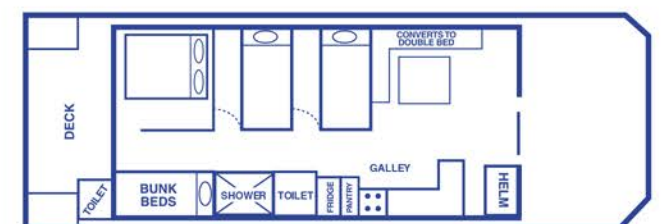

Sarah Jane 6/8 Berth

Sarah Jane has a double bed at the rear of the boat, a bunk room with 4 bunks and the 1 sofa lounge in the living room converts to a double bed. There is a spacious kitchen, a good sized living area and the front and rear decks are a good size.

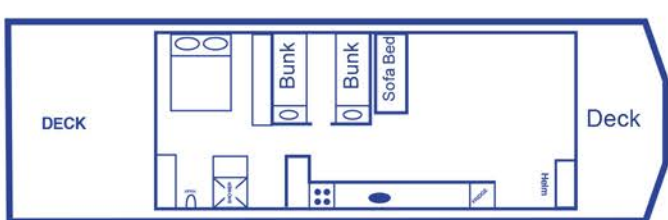

Siesta 10 Berth

This large, comfortable houseboat easily caters for 2 couples & 6 children. She offers 2 double bedrooms, a 3rd bedroom with 4 comfortable bunks, & 2 bunks in the rear passage. She has a spacious living area, with open kitchen and dining and a second toilet rear deck.

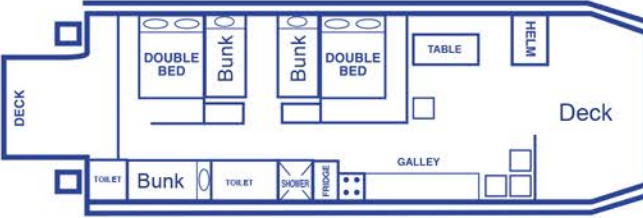

Chloe 4/6 Berth

Perfect for 2 couples with two double beds in separate rooms, a bathroom, powder room and two toilets. She has a spacious open plan living/kitchen/dining area and a large deck space front and rear. Chloe is the sister vessel to Clancy and they are almost identical but with different colour schemes. Small double sofa bed in lounge.

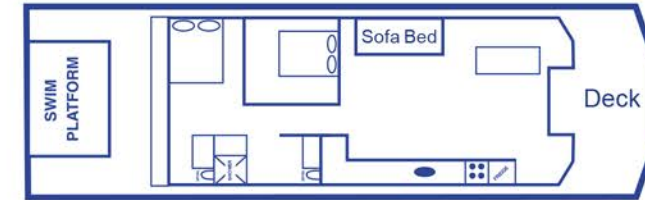

Miss Bianca 4 Berth

Popular budget family houseboat. Open planned vessel. Ideally suited for a couple, or parents with children. Sleeping arrangements are 1 double, 2 bunks.

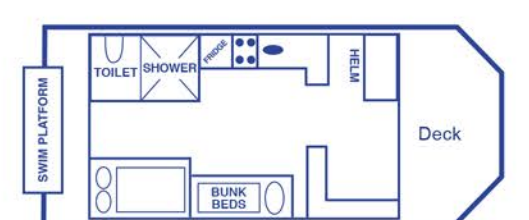

Clancy 4/6 Berth

This spacious houseboat is ideally suited for 2 couples, with 2 double bedrooms with & a large comfortable L shape lounge which can convert to 2 single berths in living area. Rear bedroom has en-suite facility, front bedroom has powder room.

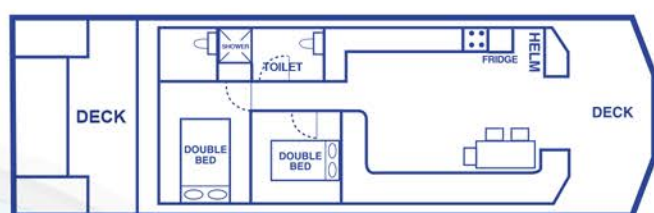

Hakuna Matata 8 Berth

("No worries"), this spacious vessel caters for 3 couples, with 3 comfortable double bedrooms, and 2 bunks in the rear alcove. Equipped with 2nd powder room and ample storage room, and large rear deck.

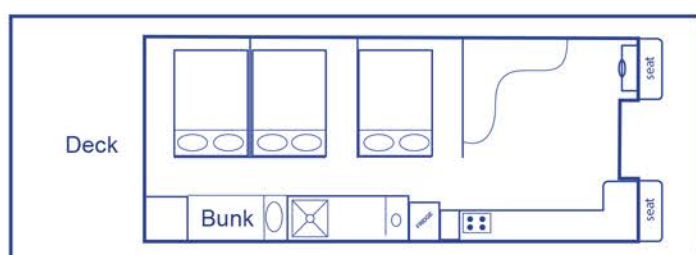

Quicksilver 8 Berth

Quicksilver has a LUXURIOUS SPA, air-conditioning/heating and tinted glass surrounds for panoramic cruising.

Suitable for two families - 2 bedrooms with double beds, 1 bedroom with 4 bunk beds. All linen is provided. First double room has access to shower/toilet, second double bedroom has powder room access. Galley includes Nespresso coffee machine, and microwave oven.

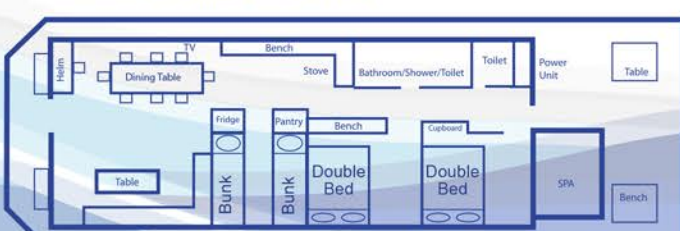

Lifestyle 6/8 Berth

Houseboat of choice for 2 couples & 2 children. Lifestyle has two comfortable double bedrooms and two bunks and a sofa bed that converts to a double bed.

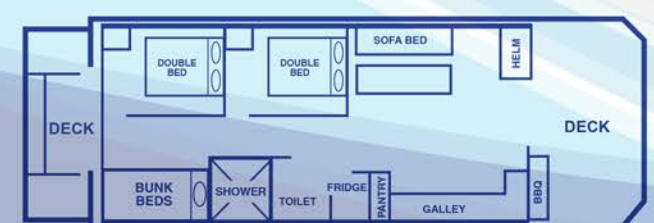

Sophie 6/10 Berth

Sophie has an open plan combined lounge/dining/kitchen area. Sophie has two double beds in separate rooms, a bunk room with one set of bunks and the two sofa lounges in the living room convert to double beds. A good sized deck on the front of the boat, a bathroom, powder room and two toilets.

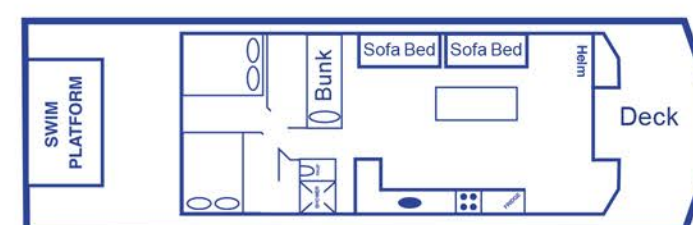

Natalie Anne 6 Berth

A Large, comfortable family houseboat with rear double bedroom, & second bedroom offering 4 spacious bunks.

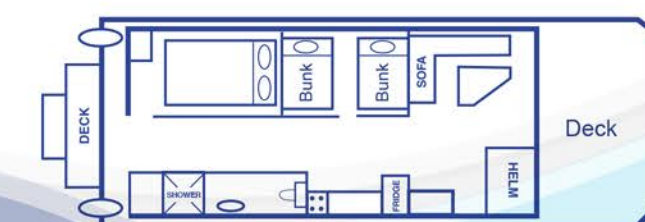

ALL VESSELS ARE EQUIPPED WITH:

- All Kitchenware, cleaning products and tea towels
- Cooktop
- Toilets and showers
- Hot water system
- Fridge/freezer
- 80L Esky
- BBQ's
- TV (Limited Reception)
- CD/DVD player
- Swim platform with ladder
- Shaded decks
- Outdoor settings
- Crab nets
- Ctrack Safety
- Tracking system
- GPS
- Inverter (to supply 240v suitable to charge mobile phones and laptops)

LEGEND

- Embarkation Mandurah Ocean Marina
- Embarkation Ravenswood